

PISTON, PISTON RING, PISTON PIN CONSTRUCTION [LF]

B3E011011010T02

- The pistons are made of aluminium alloy, which withstands heat and is highly conductive.
- The piston skirt is coated with graphite to reduce friction.
- The offset pistons are used to reduce piston-slapping noise.
- To prevent the piston from being reassembled in the wrong direction, a front mark (←) is on the piston.
- Pistons and connecting rods cannot be disassembled because they are shrinkage fit.

Piston Specification.

| | | |
|------------------------|---------|-------------------------------|
| Outer diameter | mm {in} | 87.465-87.495 {3.4435-3.4446} |
| Offset quantity | mm {in} | 0.8 {0.04} |
| Compression height: HC | mm {in} | 28.5 {1.122} |
| Piston height: HD | mm {in} | 51.0 {2.0078} |

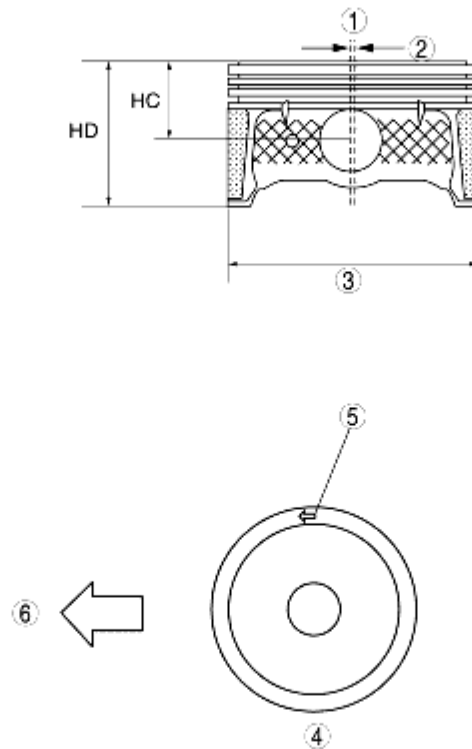

B3E01 10T055

| | |
|---|-----------------------------------|
| 1 | Piston side view |
| 2 | Offset |
| 3 | Outer diameter |
| 4 | Piston upper view |
| 5 | Install arrow facing engine front |
| 6 | Engine front side |

- The following piston rings have been adopted: Barrel face ring for top ring, taper under cut ring for second ring, 2 scuff rings and an expander for the oil ring.
- The piston pin is made of chrome steel alloy, which has superior rigidity.
- The connecting rod and the piston pin are shrinkage fit, so that it cannot be disassembled.

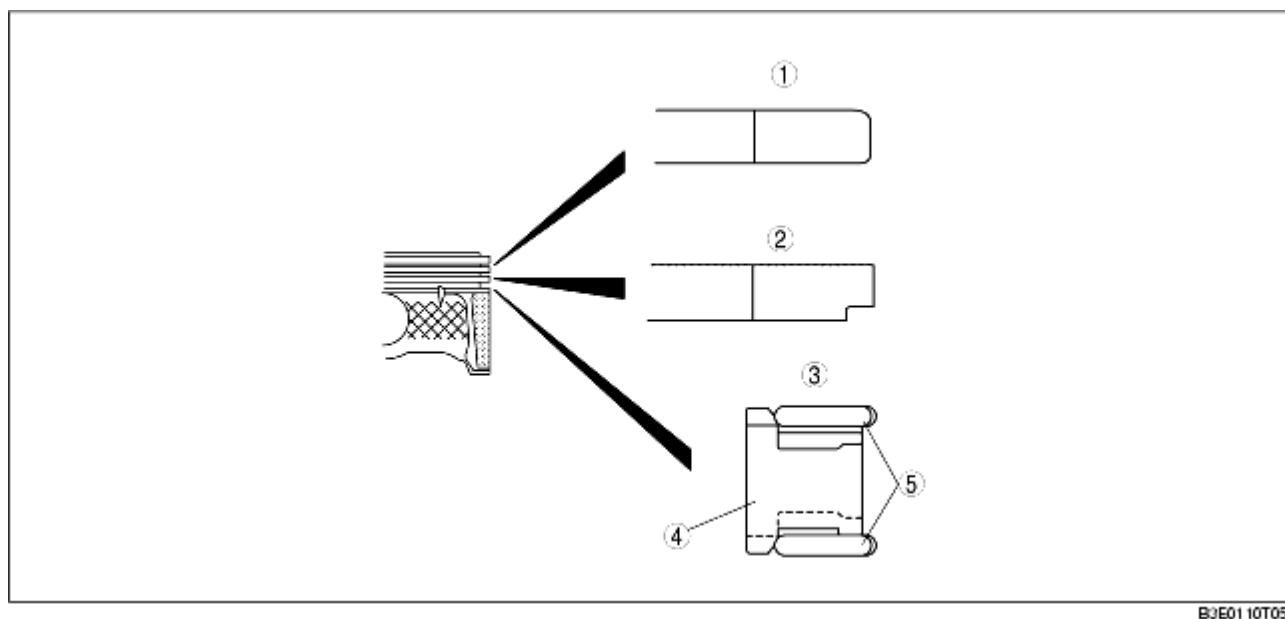

B3E01 10T056

| | |
|---|----------------------------|
| 1 | Top ring sectional view |
| 2 | Second ring sectional view |
| 3 | Oil ring sectional view |
| 4 | Expander |
| 5 | Side rail |